

disassembling original front fender

1. Loosen the screws (4) and nuts (5) of the upper bracket (6).
2. Remove the bracket and fender

Fitting the "GT/Racing" front fender

1. Mount the front fender to the motorbike with the screws (2).
Tightening torque: 15 bis 20Nm

When mounting, ensure that the unit is positioned centrally and has sufficient clearance to moving parts.

We recommend using a medium-strength screw lock (e.g. LOCTITE 243, blue) for all screws.

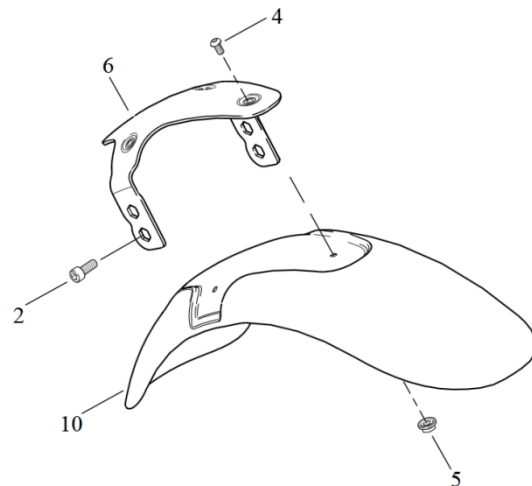

Abb. 1 – mounted front fender „GT“



Abb. 2 – front fender „GT“