

Dismantle original front fender

1. Loosen the screws (2) of the upper bracket (9).
2. Loosen bolts (3) and nuts (4) and unscrew front fender (5) from bracket (9).

Fitting the "Special" front fender

1. Mount the front fender to the bracket with bolts (3) and nuts (4).
Tightening torque: 5 - 10Nm
2. Mount the bracket on the motorbike with the screws (2).
3. Tightening torque: 25 - 30Nm

For item HD-ROD039, the screws are replaced as follows:

- DIN7984 M8x45 (black) instead of screw(2)
- ISO7380TX M6x16 (black) instead of screw(3)

The screws are included in the scope of delivery.

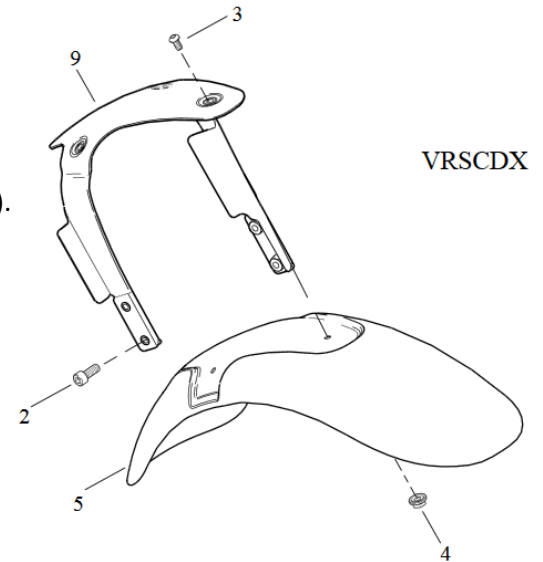

When mounting, ensure a central position (above the tyre) and sufficient clearance to moving parts.

We recommend using a medium-strength screw lock (e.g. LOCTITE 243, blue) for all screws.



Abb. 1 - Mounted front fender



Abb. 2 – front fender "Special"