

Fit the holder (2) of the already assembled nose spoiler to the frame with the screws (3) mount (1)

Tightening torque: 15 to 25Nm

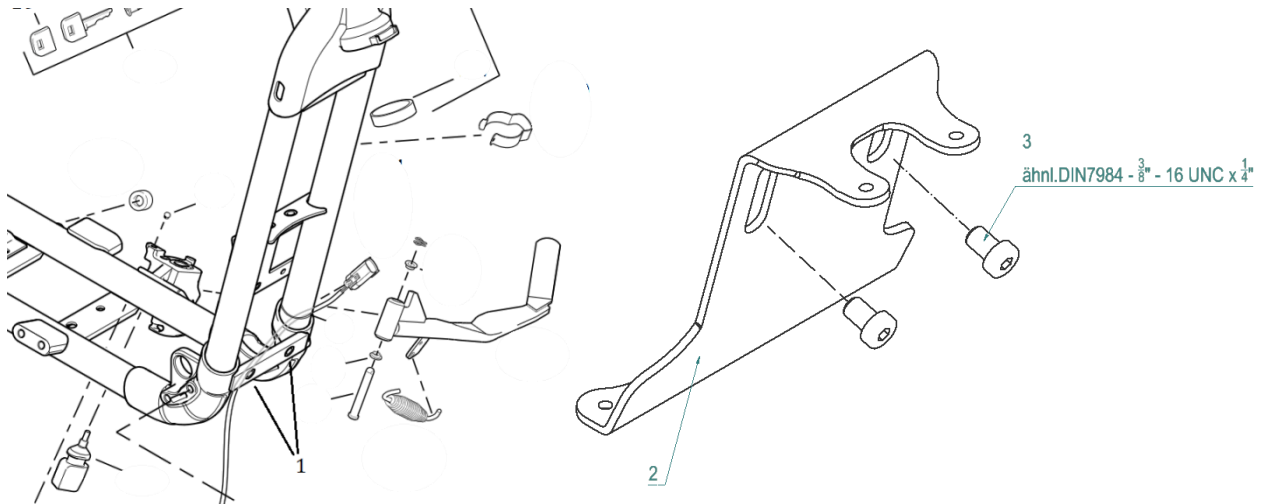

We recommend using a medium-strength screw lock (e.g. LOCTITE 243, blue) for all screws.



Abb. 1 – mounted bug spoiler



Abb. 2 – bug spoiler „Bobber“