

Original Frontfender demontieren

1. loosen the screws (2) and nuts (5) of the original fender.
2. dismantle fender

Note: Keep the original screws and nuts.

These will still be needed for subsequent assembly.

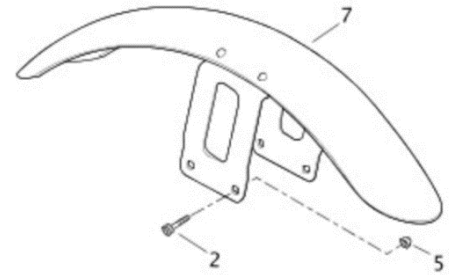

Fitting the "Bobber 883" front fender

1. Fit the side mounting plates (item 2) to the front fender (item 1) using the screws, washers and nuts supplied nuts to the front fender (pos. 1).

Tightening torque: 10 to 15Nm

2. attach the front fender and mounting plates to the motorcycle using the original bolts (2) and nuts (5) to the motorbike

Tightening torque: 25 to 30Nm

Montagematerial:
- 4x Mutter M8, niedrig
- 4x Scheibe M8
- 4x Schraube IS07380 M8x12 (nicht dargestellt)



We recommend using a medium-strength screw lock (e.g. LOCTITE 243, blue) for all screws.

